

Courtyard

Entrance (Van)



loading ramp

Backstage

Britzer Str.

Gallery

Stage

Gallery

218 m² 11,00 x 19,80 m

Height: 7,20 m (3,70 m Gallery)

Stage:
11,00 m x 12,00 m x 0,50m

Auditorium:
7 Levels a 0,20 m
99 Seats

Foyer



Main Entrance
Schnellerstr. 104

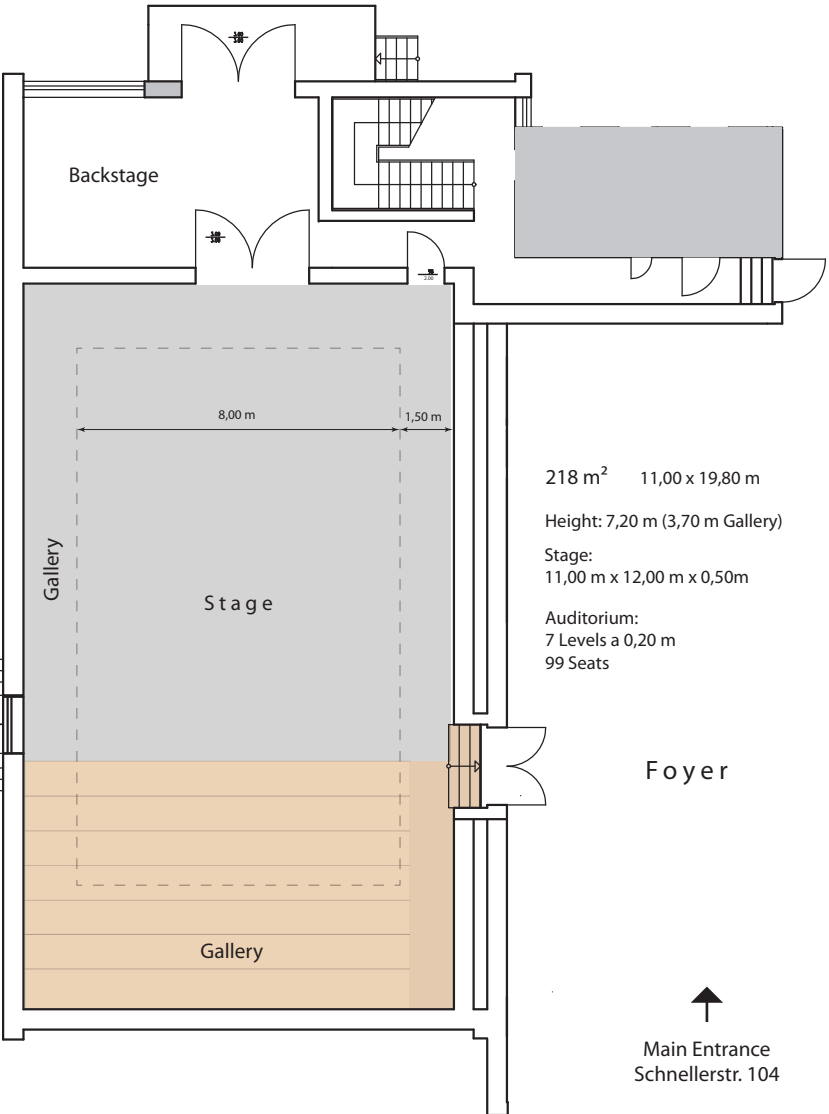

Fl.:31,27m²

Raum 35
Flur
Li.Hö.:3,20m
Fl.:15,80m²

18/30

Brücke

Brücke

Brücke

Raum 31
WC
Li.Hö.:3,1
Fl.:8,89m²

Raum 31
Garderob
Li.Hö.:4,0
Fl.:12,74m²

Brücke

Raum 6

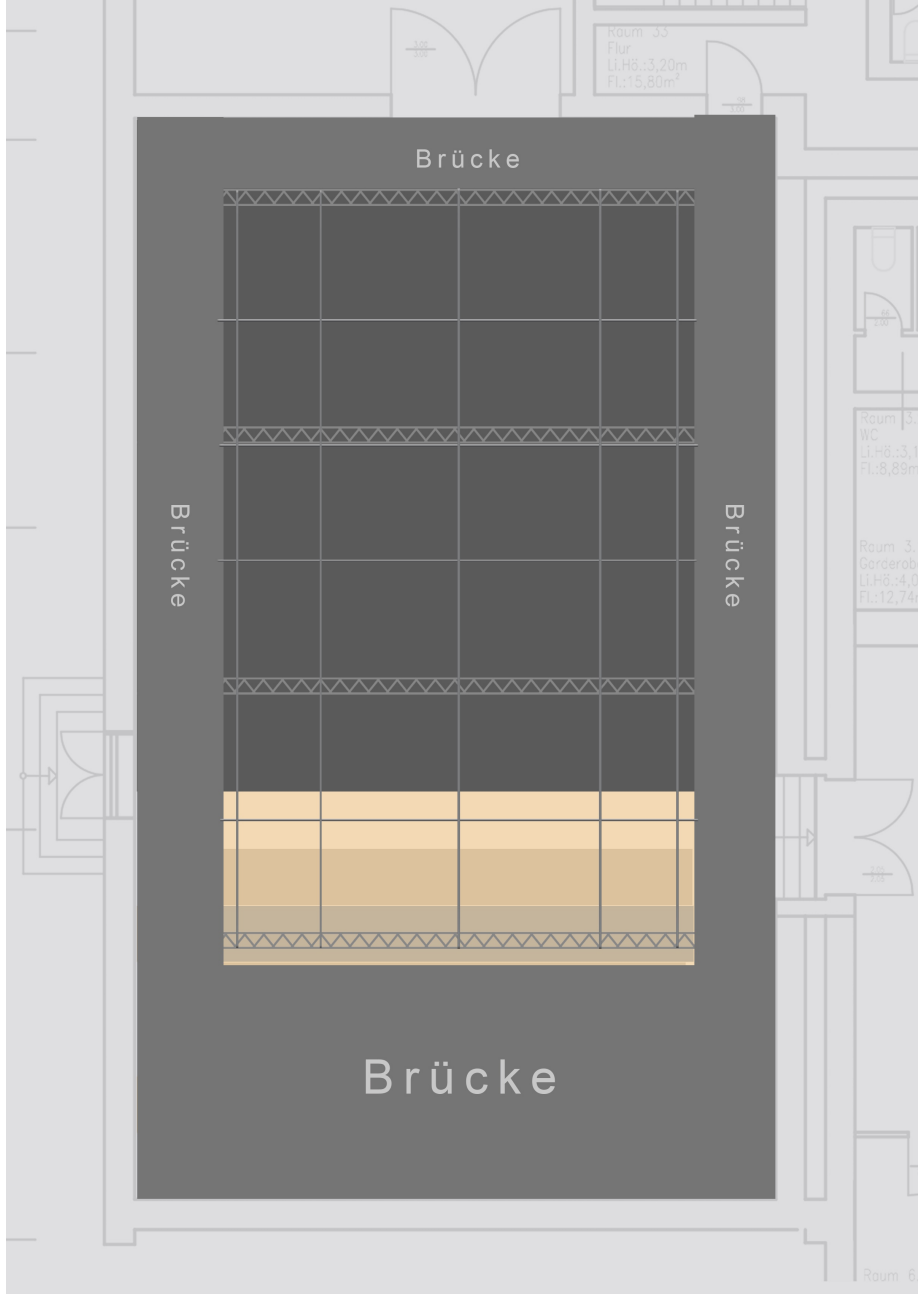

LIGHTING

Controls

<i>Control Desk</i>	Zero88 FLX	2048 DMX Channels 240 Subgroups / Cue list / Playbacks programmable Master Playback / Go Taste, USB Storage extensive library + external 23" Touchscreen ZerOS Remote - control via Tablet, Smartphone	1
<i>Dimmer</i>	Liteputer DX-1210	12 CH- Dimmer, 32A, DMX 512	8
		Dimmer circuit (2KW, 10A)	96

Lights

<i>Fresnel 1000 W</i>	ETC S4 FR	with Barndoor, 20-65° (750 W HPL)	30
	Robert Juliat - Lutin	6-45°, 150 mm, Barndoor	4
	Sintesi Area	with Barndoor	6
<i>Profiler 1000 W</i>	ETC S4 Zoom	25-50°, Irisblende (750 W HPL)	6
	Sintesi Figura	Zoom 13-35°	2
<i>Profiler 650 W</i>	ETC S4 jr Zoom	25-50°, Iris, (575 W HPL)	8
<i>Profiler LED</i>	ETC ColorSource Spot jr	RGB, Lime, (Deep Blue) 25-50°, Iris, RDM	10
<i>Flood / Wash LED</i>	Litecraft WashX.21	RGBW, DMX, no fan, 21 x 10W, 11 Channels	6
<i>Par LED</i>	ETC ColorSource DB	RGB, Lime, (Deep Blue), 8 x 10 W, RDM	9
<i>Par 1000 W</i>	PAR 64	long, black, CP62 MFL (medium flood)	8
<i>Stands</i>	K&M	High stand, Tripod (max 300 cm)	6
	K&M	Floor stand	6

SOUND

PA

Mixers	Yamaha TF-1	digital - 16/32 IN, 16 Outputs, Dante Card, Monitor mix via Yamaha App	1
	Soundcraft Signature 16	analogue - 12 Mic IN, 4 Stereo IN, FX, 4 Aux, 4 Sub	1
Stagebox	Yamaha Tio 1608-D	digital, 16/8 CH	2
	Cordial	analogue, 8/4 CH, 15m	1
Speakers	EV ETX 12 P	active, 12" Speaker, 2000W	2
	EV ETX 35 P	active, 12" / 1,25" Compression driver, 2000W	2
	EV ETX 18SP	active, 18" Speaker 1800W	2
Monitor Speakers	EV PXM-12MP	active, 12"/1x 1,75" driver, Coaxial Speaker, 700 W	3
DI- Box	DBX	2-Channel, passiv	4

Microphones

dynamic	Shure Beta 58 A	Vocals	5
	Shure Beta 57 A	Sax, SN, Guitar Amp	3
dynamic, wireless	Shure Beta 58 A BLX	Vocals	3
	Sennheiser ew 500 G4	Vocals, Sprache (Handsender mit e945 Kapsel)	2
Condenser	AKG C 1000s MKIV	Acoustic guitar, Speech	2
	Rode NT 5	small diaphragm, cardioid characteristic, Recording	4
Gooseneck	AKG CGN 99 HL	hypercardioid, Condenser, Speech, conference	4
Condenser Boundary Layer	Sennheiser 912 S BK	half cardioid, Speech, conference	2
Drum mic set	AKG Perception Live	1 x BD, 3 x SN/TT , 2 x OH	1
Stands (Mic)	K&M	Round base	3
		Round base with Boom Arm	3
		Round base with Boom Arm, small	2
		Tripod with Boom Arm	div.

VIDEO

<i>Projector</i>	Optoma ZU720T	DLP Projector, 1920 x 1080 WUXGA, 7.500 lumens, 4-corner geometry adjustment, 1.8x zoom, vertical and horizontal lens shift HDMI 1.4 (MHL), HDMI 2.0, VGA...	1
<i>Video Mixer</i>	Roland V-02HD	2 x Input HDMI, 1 x Output HDMI, 1 x Preview Output HDMI	1
<i>Shutter</i>	Blacky 3.0	DMX (1 Channel)	1
<i>Projection Screen</i>	AV Stumpfl Vario 64	movable, to stand or hang, 16:9, 630 x 350 cm (external dimensions 650 x 370) 2 projection cloths front/rear	1

OTHERS

<i>Piano</i>	Yamaha b1PE	Acoustic, 88 Keys, 3 Pedals, 109cm, black	1
	Yamaha P-45b	Stage Piano, Graded Hammer Standard keyboard, 88 weighted keys, Sustain-Pedal	1
<i>Orchestra stand</i>	K&M	Tripod, black	3
<i>Dancefloor Carpet</i>	Vario 200	200 cm, black/white, 11,00 x 10,00 m	
<i>Stage Risers</i>	Bütec / Standard	2 m x 1 m, dark	15
		Telescopic legs 30 - 45 cm	60
		Telescopic legs 60 - 100 cm	24
<i>Stage weight</i>	C. Adolph	6,4 Kg, cast iron, black	10
<i>Work Platform Lift</i>	Genie AWP 20S		1